

SCHAEFER

LEGENDARY STRENGTH

TDH-900

(TRANSOM DOOR HANDLE AND CATCH PLATE)

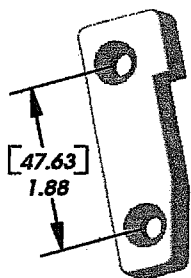

CATCH PLATE

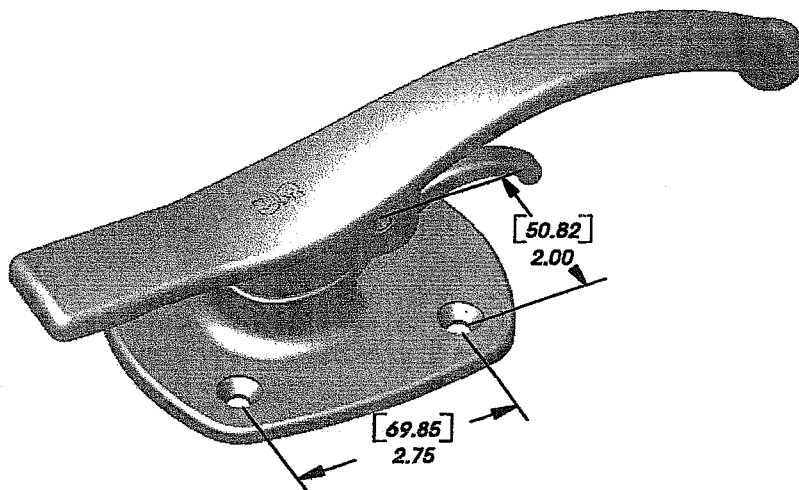

TRANSOM DOOR HANDLE ASSY

NOTE: #TDH-900 INCLUDES BOTH DOOR HANDLE ASSEMBLY AND CATCH PLATE

TRANSOM DOOR HANDLE SPECIFICATIONS:

1. MATERIAL IS 316 S/S HAND BUFFED AND ELECTRO-POLISHED
2. TOTAL HEIGHT = 2-3/4" (70mm)
3. TOTAL LENGTH = 9-5/8" (244mm)
4. BASE PLATE DIM'S = 4-1/2" (114mm) X 3-1/2" (89mm)
5. WEIGHT = 2.8 LBS (1.27kg)
6. FASTENERS = (4) 1/4" F.H. SCREWS
7. SPRING LOADED TRIGGER STYLE LATCH SECURELY LOCKS INTO POSITION AND ALLOWS FOR (1) HANDED OPERATION
8. LARGE CENTER SHAFT RIDES ON PLASTIC BEARINGS FOR SMOOTH OPERATION
9. SMOOTHLY CONTOURED HANDLE ALLOWS FOR COMFORTABLE YET SECURE GRIP

CATCH PLATE SPECIFICATIONS:

1. MATERIAL IS 316 S/S HAND BUFFED AND ELECTRO-POLISHED
2. WEIGHT = 5oz (142g)
3. BOTH SIDES CSK FOR 1/4" FH SCREW FOR LEFT OR RIGHT HAND MOUNTING